

Object Detection

DC 3-wire · Tubular housings
 Ø 10 mm, M12



Housing size	Ø 10 mm	M12x1	M12x1
Mounting	flush	flush	non-flush
Rated switching distance s_n	1...4 mm	0.1...4 mm	1...8 mm
With sensor amplifier	Ordering code	BCS0018	BCS0019
	Part number	BCS M12T4D-XXS40C-EP02-GZ01-002	BCS M12T4D1-XXS80G-EP02-GZ01-002
PNP Normally open	Ordering code	BCS002T	
	Part number	BCS G10T4H-PSM40C-EP02	
PNP Normally closed	Ordering code	BCS002U	
	Part number	BCS G10T4H-POM40C-EP02	
NPN Normally open	Ordering code	BCS002W	
	Part number	BCS G10T4H-NSM40C-EP02	
NPN Normally closed	Ordering code	BCS002Y	
	Part number	BCS G10T4H-NOM40C-EP02	
Supply voltage U_s	12...35 V DC	4...8 V DC	4...8 V DC
Voltage drop U_a at I_o	≤ 0.8 V		
Rated insulation voltage U_i	75 V DC	75 V DC	75 V DC
Output current max.	200 mA		
No-load supply current I_o max.	≤ 10 mA		
Reverse polarity/short circuit protected	yes/yes		
Ambient temperature range T_a	-30...+70 °C	-30...+80 °C	-30...+80 °C
Switching frequency f	100 Hz	100 Hz	100 Hz
Output function indicator	LED yellow		
Degree of protection per IEC 60529	IP 65	IP 67	IP 67
Material			
Housing	V2A	V2A	V2A
Sensing face	PTFE	PTFE	PTFE
Cover	POM	POM	POM
Wiring	2 m cable PUR, 3x0.14 mm ²	2 m cable PUR, 3x0.14 mm ²	2 m cable PUR, 3x0.14 mm ²

For sensor amplifiers see
 Accessories section
 Page 71

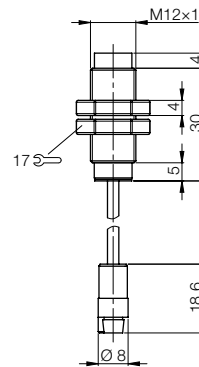
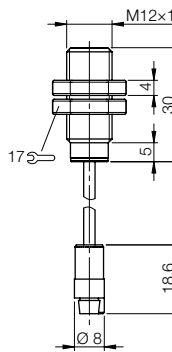
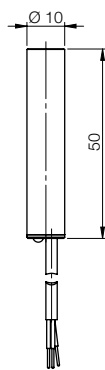

The flush mount sensors for object detection M12...M30 in plastic or PTFE housing provide IP 68 protection (at approx. 5 bar) at the sensing face.

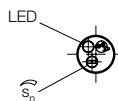

Object Detection

DC 3-wire · Tubular housings
M12, M18



**DC 3-wire
Tubular housings**
Disc types
Block-style
Stick-on sensor

DC 4-wire
Dynamic function
diagnostics

M12×1 flush 1...4 mm	M12×1 flush 1...4 mm	M12×1 flush 1...4 mm	M12×1 flush 1...4 mm	M18×1 flush 2...8 mm
BCS0037 BCS M12T4D2-PSM40C-S04G	BCS002Z BCS M12T4G1-PSM40C-EP02	BCS003T BCS M12WVD2-PSM40C-S04G	BCS003M BCS M12VVG1-PSM40C-EP02	BCS0047 BCS M18B4G2-PSC80C-S04G
BCS0038 BCS M12T4D2-POM40C-S04G	BCS0030 BCS M12T4G1-POM40C-EP02	BCS003U BCS M12WVD2-POM40C-S04G	BCS003N BCS M12VVG1-POM40C-EP02	BCS0049 BCS M18B4G2-POC80C-S04G
BCS0039 BCS M12T4D2-NSM40C-S04G	BCS0031 BCS M12T4G1-NSM40C-EP02	BCS003W BCS M12WVD2-NSM40C-S04G	BCS003P BCS M12VVG1-NSM40C-EP02	BCS004C BCS M18B4G2-NSC80C-S04G
BCS00AC BCS M12T4D2-NOM40C-S04G	BCS0032 BCS M12T4G1-NOM40C-EP02	BCS003Y BCS M12WVD2-NOM40C-S04G	BCS003R BCS M12VVG1-NOM40C-EP02	BCS004F BCS M18B4G2-NOC80C-S04G
12...35 V DC ≤ 0.8 V 75 V DC 200 mA ≤ 10 mA yes/yes -30...+70 °C 100 Hz LED yellow IP 65 V2A PTFE PA M12 connector, 4-pin, A-coded	12...35 V DC ≤ 0.8 V 75 V DC 200 mA ≤ 10 mA yes/yes -30...+70 °C 100 Hz LED yellow IP 65 V2A PTFE POM 2 m cable PUR 3×0.14 mm ²	12...35 V DC ≤ 0.8 V 75 V DC 200 mA ≤ 10 mA yes/yes -30...+60 °C 100 Hz LED yellow IP 65 PVC PVC PA M12 connector, 4-pin, A-coded	12...35 V DC ≤ 0.8 V 75 V DC 200 mA ≤ 10 mA yes/yes -30...+70 °C 100 Hz LED yellow IP 65 PVC PVC PVC 2 m cable PUR 3×0.14 mm ²	10...35 V DC ≤ 1.5 V 75 V DC 300 mA ≤ 10 mA yes/yes -30...+70 °C 100 Hz LED yellow IP 67 V2A PBT PA M12 connector, 4-pin, A-coded

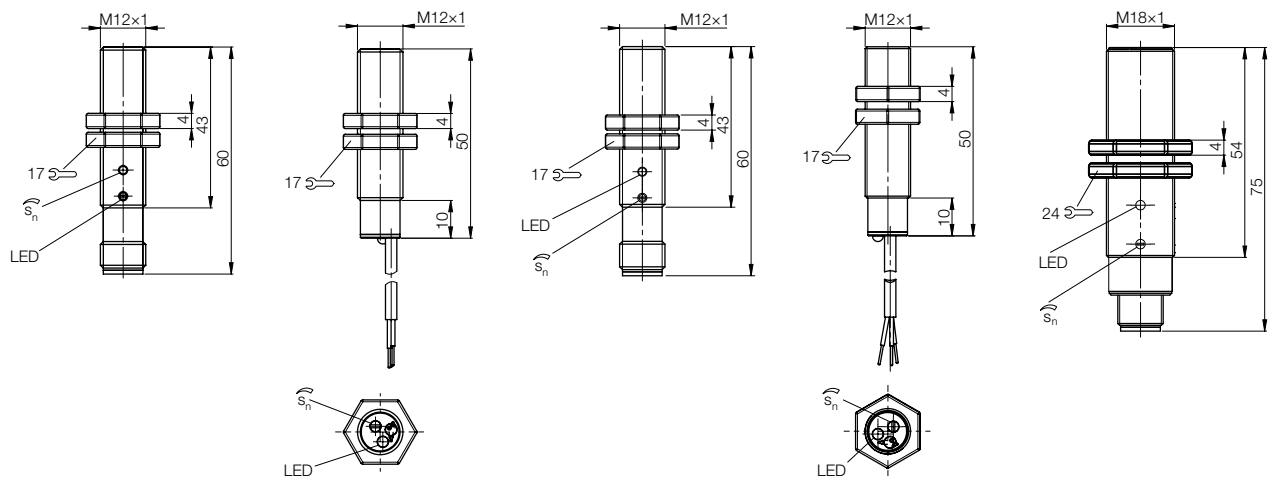

Electrical devices,
connectors and
holders see
Accessories
section starting
page 69

