

# DF-G2 High Speed Expert™ Dual Display Fiber Amplifier with IO Link



## Quick Start Guide

Advanced Sensor with Dual Discrete Outputs and IO-Link Communication for Use with Plastic and Glass Fiber Optic Assemblies

To view or download the latest technical information about this product, including specifications, dimensions, accessories, and wiring, see [www.bannerengineering.com](http://www.bannerengineering.com).



### WARNING: Not To Be Used for Personnel Protection

**Never use this device as a sensing device for personnel protection. Doing so could lead to serious injury or death.** This device does not include the self-checking redundant circuitry necessary to allow its use in personnel safety applications. A sensor failure or malfunction can cause either an energized or de-energized sensor output condition.

## Overview

Figure 1. DF-G2 IO Link Model Features

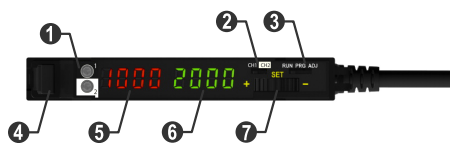

1. Output LED
2. CH1/CH2 Switch
3. RUN/PRG/ADJ Mode Switch
4. Lever Action Fiber Clamp
5. Red Signal Level
6. Green Threshold
7. +/-SET/- Rocker Button

## Models

Model	Sensing Beam Color	Reference Sensing Range <sup>1</sup>	Channel 1	Channel 2	Connector <sup>2</sup>
DF-G2-KD-2M	Visible Red	1100 mm	IO-Link, push/pull output	PNP only output, or input	2 m (6.5 ft) cable, 4-wire
DF-G2IR-KD-2M	Infrared	2100 mm			

## Installation Instructions

### Mounting Instructions

#### Mount on a DIN Rail

1. Hook the DIN rail clip on the bottom of the DF-G2 over the edge of the DIN rail (1).
2. Push the DF-G2 up on the DIN rail (1).
3. Pivot the DF-G2 onto the DIN rail, pressing until it snaps into place (2).

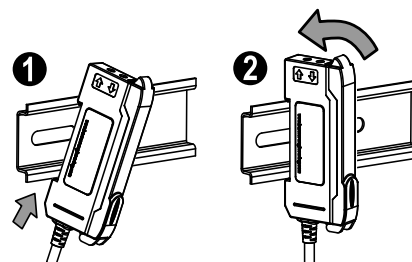

<sup>1</sup> Excess gain = 1, Long Range response speed, opposed mode sensing. PIT46U plastic fiber used for visible LED models, IT.83.3ST5M6 glass fiber used for IR model

<sup>2</sup> Connector options:

- A model with a QD connector requires a mating cordset
- For 150 mm (6 in) PVC, M8 Pico QD connector, 4-pin change the suffix 2M to Q3 in the 2 m model number (example, DF-G2-KD-Q3)
- For 150 mm (6 in) PVC, M12 Euro QD connector, 4-pin change the suffix 2M to Q5 in the 2 m model number (example, DF-G2-KD-Q5)
- For integral M8 Pico QD connector, 4-pin change the suffix 2M to Q7 in the 2 m model number (example, DF-G2-KD-Q7)



## Mount to the Accessory Bracket (SA-DIN-BRACKET)

1. Position the DF-G2 in the SA-DIN-BRACKET.
2. Insert the supplied M3 screws.
3. Tighten the screws.

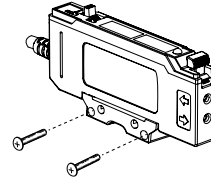

## Remove from a DIN rail

1. Push the DF-G2 up on the DIN rail (1).
2. Pivot the DF-G2 away from the DIN rail and remove it (2).

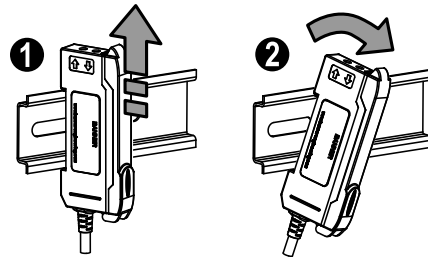

## Installing the Fibers

Follow these steps to install glass or plastic fibers.

1. Open the dust cover.
2. Move the fiber clamp forward to unlock it.
3. Insert the fiber(s) into the fiber port(s) until they stop.
4. Move the fiber clamp backward to lock the fiber(s).
5. Close the dust cover.

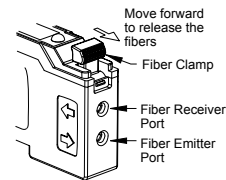

**Note:** For optimum performance of IR models, if applicable, glass fibers must be used.

## Fiber Adapters



**Note:** If a thin fiber with less than 2.2 mm outer diameter is used, install the fiber adapter provided with the fiber assembly to ensure a reliable fit in the fiber holder. Align the fibers to the end of the adaptors. Banner includes the adapters with all fiber assemblies.

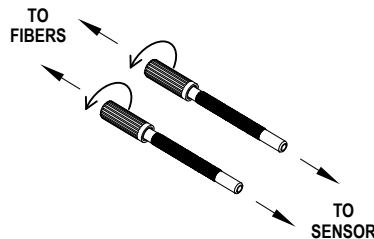

Fiber Outer Diameter (mm)	Adapter Color
Ø 1.0	Black
Ø 1.3	Red
Ø 2.2	No adapter needed

When connecting coaxial-type fiber assemblies to the amplifier, install the single-core (center) fiber to the Transmitter port, and the multi-core (outer) fiber to the Receiver port. This will result in the most reliable detection.

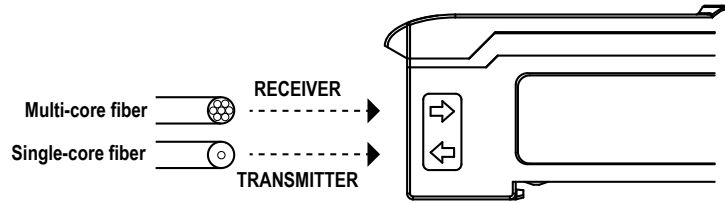

## Wiring Diagrams

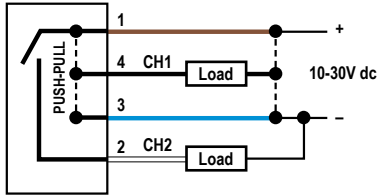

Figure 2. Channel 1 as a Push-Pull discrete output, Channel 2 as PNP discrete output

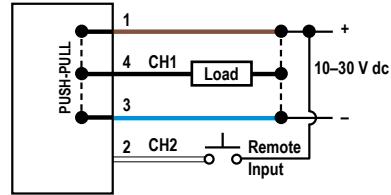

Figure 3. Channel 1 as a Push-Pull discrete output, Channel 2 as remote input

### Key

- 1 = Brown
- 2 = White
- 3 = Blue
- 4 = Black



**Note:** Open lead wires must be connected to a terminal block.



**Note:** The Channel 2 wire function is user-selectable. The default is independent Light Operate (LO) PNP output. See the Remote Input section for details regarding use as remote input or the Sync Master/Slave section for use as a synchronization output.

## Top Panel Interface

Opening the dust cover provides access to the top panel interface. The top panel interface consists of the RUN/PRG/ADJ mode switch, CH1/CH2 switch, +/-SET/- rocker button, dual red/green digital displays, and output LED.

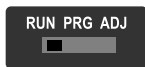

### RUN/PRG/ADJ Mode Switch

The RUN/PRG/ADJ mode switch puts the sensor in RUN, PRG (Program), or ADJ (Adjust) mode.

- RUN mode allows the sensor to operate normally and prevents unintentional programming changes via the +/-SET/- rocker button.
- PRG mode allows the sensor to be programmed through the display-driven programming menu (see Program Mode).
- ADJ mode allows the user to perform Expert TEACH/SET methods and Manual Adjust (see Adjust Mode).



### CH1/CH2 Switch (Dual Output Mode)

The CH1/CH2 switch selects which output's parameters can be accessed and changed in the interface of the display.

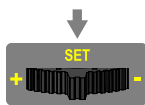

### +/-SET/- Rocker Button

The +/-SET/- rocker button is a 3-way button. The +/- positions are engaged by rocking the button left/right. The SET position is engaged by clicking down the button while the rocker is in the middle position. All three button positions are used during PRG mode to navigate the display-driven programming menu. During ADJ mode, SET is used to perform TEACH/SET methods and +/- are used to manually adjust the threshold(s). The rocker button is disabled during RUN mode, except when using Window SET.



### Red/Green Digital Displays

During RUN and ADJ modes, the Red display shows the signal level, and the Green display shows the threshold or the total counts. During PRG mode, both displays are used to navigate the display-driven programming menu.



### Dual Output LEDs

The output LEDs provide a visible indication when the associated output is active (conducting).

- 1 represents the Channel 1 output
- 2 represents the Channel 2 output

## Operating Instructions

---

### Remote Input

For more information about how to perform TEACH/SET methods and to program the sensor remotely, see [www.bannerengineering.com](http://www.bannerengineering.com) and search 193602.

### Run Mode



Run mode allows the sensor to operate normally and prevents unintentional programming changes. The +/-SET/- rocker button is disabled during RUN mode, except when using Window SET.

### Program Mode



Program (PRG) mode allows the following settings to be programmed in the DF-G2.

**CH 1 Factory Default Settings:**

Setting	Factory Default
Out SEL1	LO
tch SEL1	2-pt tch
rESP SPd	250 us
OFSt Pct1	10 Pct
Auto thr1	oFF
dLY SEL1	oFF
SEnS SEL1	high
diSP rEAd	diSP 1234
GAIn SEL	Auto

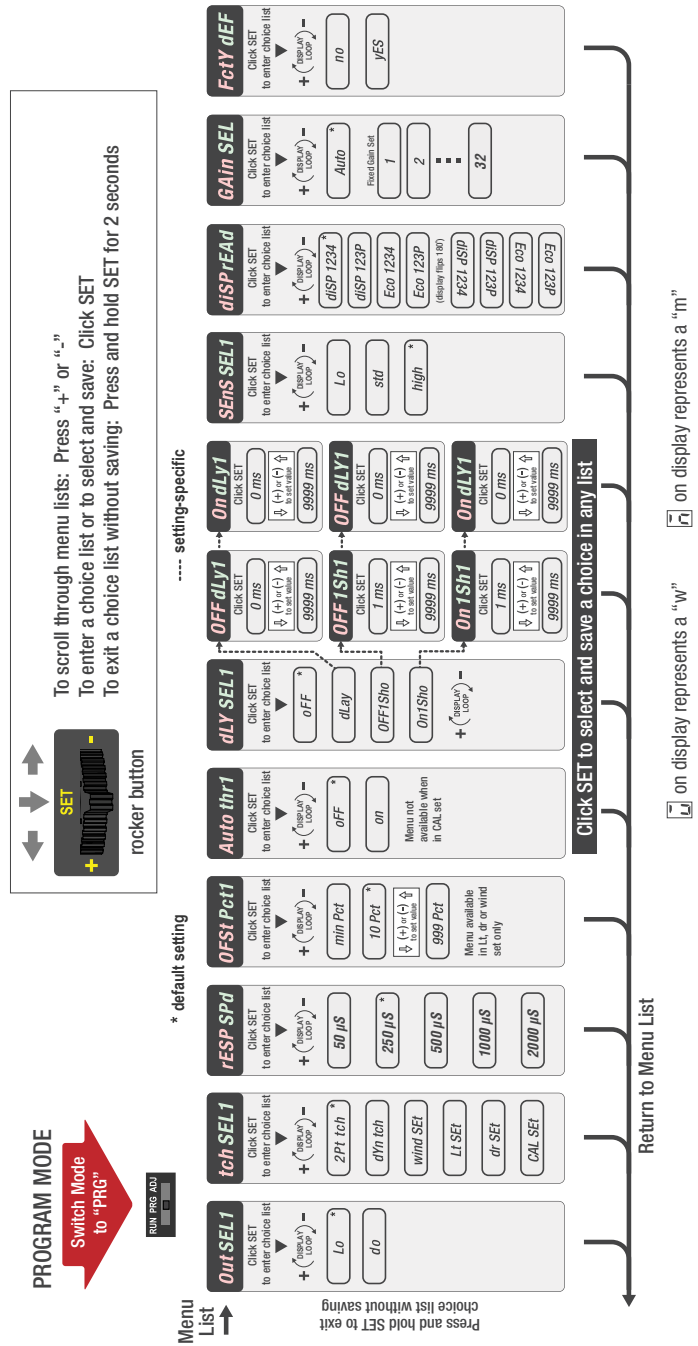

Figure 4. CH 1 Program Mode Chart

CH 2 Factory Default Settings:

Setting	Factory Default
Out SEL2	LO
tch SEL2	2-pt tch
OFSt Pct2	10 Pct
Auto thr2	oFF
dLY SEL2	oFF
SEnS SEL2	high

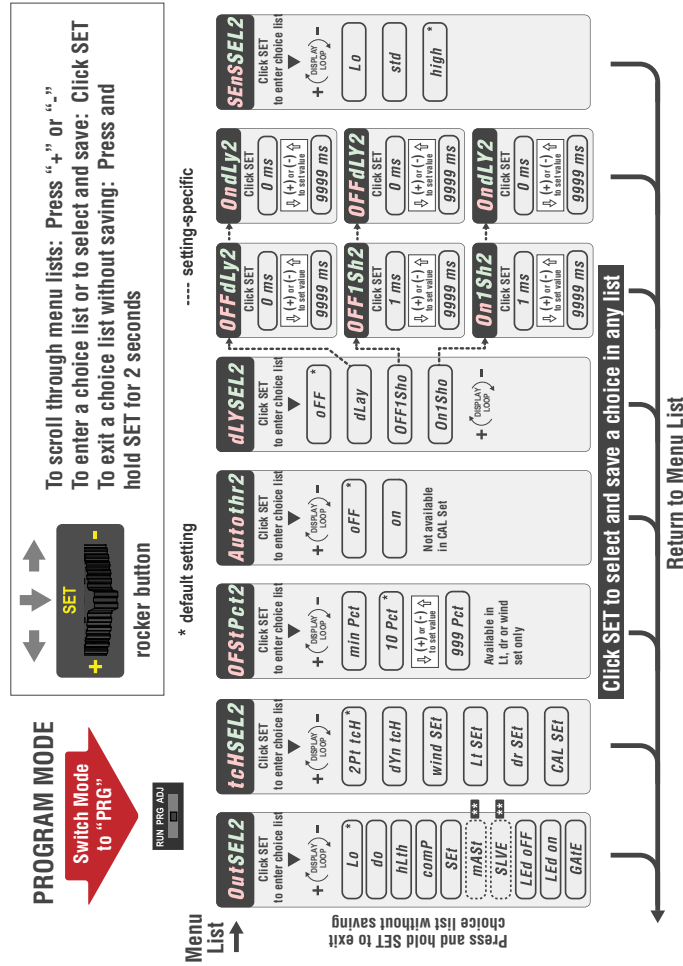
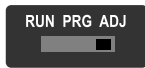

Figure 5. CH 2 Program Mode Chart

\*\* If Master (mASl), indicate number of Slaves (1..6) under subsequent "totL SLAV" menu option  
 \*\* If Slave (SLVE), indicate its address (Master address is 0) under subsequent "SLAV AdDr" menu option

Adjust Mode



TEACH Procedures

The instruction manual has detailed instructions for these TEACH modes:

- Two-Point TEACH
- Dynamic TEACH
- Window SET
- Light SET
- Dark SET
- Calibration SET

Two-Point TEACH

- Establishes a single switching threshold
- Threshold can be adjusted by using the "+" and "-" rocker button (Manual Adjust)

Two-Point TEACH is used when two conditions can be presented statically to the sensor. The sensor locates a single sensing threshold (the switch point) midway between the two taught conditions, with the Output ON condition on one side, and the Output OFF condition on the other.

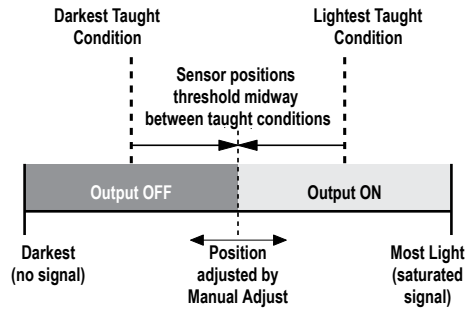

Figure 6. Two-Point TEACH (Light Operate shown)

The Output ON and OFF conditions can be reversed by changing the LO/DO setting in the Program Mode menu.

### Dynamic TEACH

- Teaches on-the-fly
- Establishes a single switching threshold
- Threshold can be adjusted using "+" and "-" rocker button (Manual Adjust)

Dynamic TEACH is best used when a machine or process may not be stopped for teaching. The sensor learns during actual sensing conditions, taking multiple samples of the light and dark conditions and automatically setting the threshold at the optimum level.

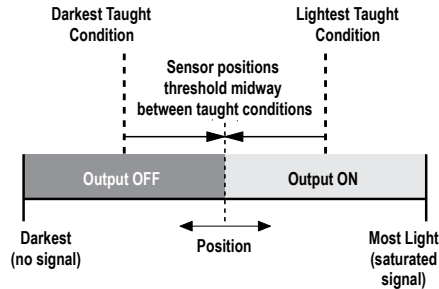

Figure 7. Dynamic TEACH (Light Operate shown)

The Output ON and OFF conditions can be reversed by changing the LO/DO setting in the Program Mode menu.

### Window SET

- Sets window thresholds that extend a programmable % offset above and below the presented condition
- All other conditions (lighter or darker) cause the output to change state
- Sensing window center can be adjusted using "+" and "-" rocker button (Manual Adjust)
- Recommended for applications where a product may not always appear in the same place, or when other signals may appear
- See Program Mode in the user's manual for programming the Offset Percent setting (to increase/decrease the window size)

A single sensing condition is presented, and the sensor positions window thresholds a programmable % offset above and below the presented condition. In LO mode, Window SET designates a sensing window with the Output ON condition inside the window, and the Output OFF conditions outside the window.



**Note:** For Window SET and Light SET, the maximum offset threshold percent is 90%.

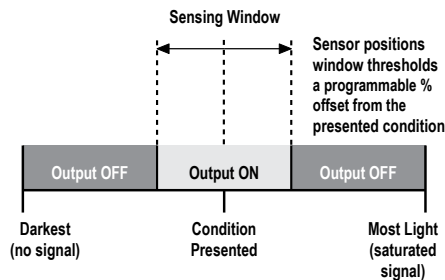

Figure 8. Window SET (Light Operate shown)

Output ON and OFF conditions can be reversed by changing the LO/DO setting in the Program Mode menu.

## Light SET

- Sets a threshold a programmable % offset below the presented condition
- Changes output state on any condition darker than the threshold condition
- Threshold can be adjusted using "+" and "-" rocker button (Manual Adjust)
- Recommended for applications where only one condition is known, for example a stable light background with varying darker targets
- See Program Mode for programming the Offset Percent setting

A single sensing condition is presented, and the sensor positions a threshold a programmable % offset below the presented condition. When a condition darker than the threshold is sensed, the output either turns ON or OFF, depending on the LO/DO setting.

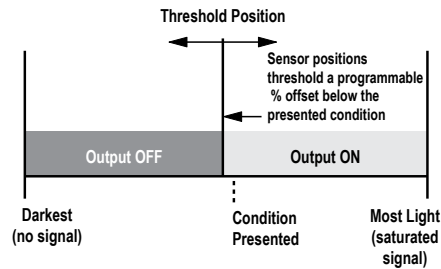

Figure 9. Light SET (Light Operate shown)

## Dark SET

- Sets a threshold a programmable % offset above the presented condition
- Any condition lighter than the threshold condition causes the output to change state
- Threshold can be adjusted using "+" and "-" rocker button (Manual Adjust)
- Recommended for applications where only one condition is known, for example a stable dark background with varying lighter targets
- See Program Mode for programming the Offset Percent setting



**Note:** Offset Percent MUST be programmed to **Minimum Offset** to accept conditions of no signal (0 counts).

A single sensing condition is presented, and the sensor positions a threshold a programmable % offset above the presented condition. When a condition lighter than the threshold is sensed, the output either turns ON or OFF, depending on the LO/DO setting.

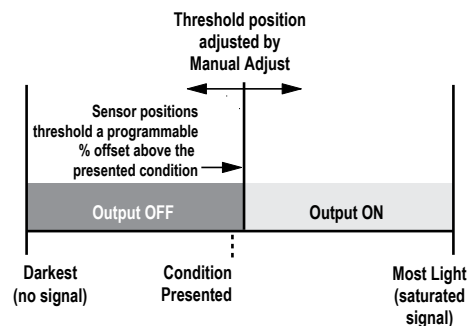

Figure 10. Dark SET (Light Operate shown)

## Calibration SET

- Sets a threshold exactly at the presented condition
- Threshold can be adjusted using "+" and "-" rocker button (Manual Adjust)

A single sensing condition is presented, and the sensor positions a threshold exactly at the presented condition. When a condition lighter than the threshold is sensed, the output either turns ON or OFF, depending on the LO/DO setting.



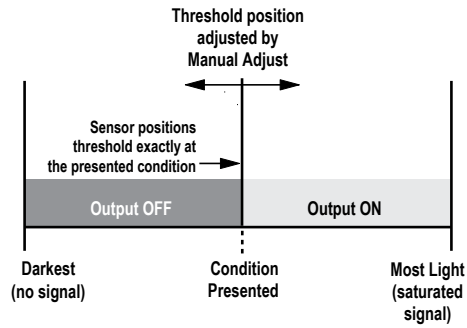

Figure 11. Calibration SET (Light Operate shown)

## Troubleshooting

### Manual Adjustments Disabled

Manual adjustments are disabled when Auto Thresholds are ON. If a manual adjustment is attempted while Auto Thresholds are ON, the Green display will flash Auto.

### Percent Minimum Difference after TEACH

The Two-Point and Dynamic TEACH methods will flash a % minimum difference on the displays after a PASS or FAIL.

Value	PASS/FAIL	Description
0 to 99%	FAIL	The difference of the taught conditions does not meet the required minimum
100 to 300%	PASS	The difference of the taught conditions just meets/exceeds the required minimum, minor sensing variables may affect sensing reliability
300 to 600%	PASS	The difference of the taught conditions sufficiently exceeds the required minimum, minor sensing variables will not affect sensing reliability
600% +	PASS	The difference of the taught conditions greatly exceeds the required minimum, very stable operation

### Percent Offset after SET

The Window, Dark, and Light SET methods will flash a % offset on the displays after a PASS or FAIL.

SET Result	% Offset Meaning
PASS (with % Offset)	Displays the % offset used for the SET method
FAIL (with % Offset)	Displays the minimum required % offset necessary to PASS the SET method
FAIL (without % Offset)	Presented condition cannot be used for the SET method

### Threshold Alert or Threshold Error

Severe contamination/changes in the taught condition can prevent the Auto Thresholds algorithm from optimizing the threshold(s).

State	Display	Description	Corrective Action
Threshold Alert	Alternates <span style="background-color: black; color: red; padding: 2px;">thr</span> <span style="background-color: black; color: green; padding: 2px;">ALrt</span> and <span style="background-color: black; color: red; padding: 2px;">1234</span> <span style="background-color: black; color: green; padding: 2px;">1234</span>	The threshold(s) cannot be optimized, but the sensor's output will still continue to function	Cleaning/correcting the sensing environment and/or a re-teach of the sensor is highly recommended
Threshold Error	<span style="background-color: black; color: red; padding: 2px;">thr</span> <span style="background-color: black; color: green; padding: 2px;">Err</span>	The threshold(s) cannot be optimized, and the sensor's output will stop functioning	Cleaning/correcting the sensing environment and/or a re-teach of the sensor is required

# Specifications

## Sensing Beam

DF-G2: Visible red, 635 nm  
 DF-G2IR: Infrared, 850 nm

## Supply Voltage

10 V to 30 V dc Class 2 (10% maximum ripple)

## Power and Current Consumption (exclusive of load)

**Standard display mode:** 960 mW, Current consumption < 40 mA at 24 V dc  
**ECO display mode:** 720 mW, Current consumption < 30 mA at 24 V dc

## Supply Protection Circuitry

Protected against reverse polarity and transient overvoltages

## Delay at Power-Up

500 milliseconds maximum; outputs do not conduct during this time

## Output Configuration

CH1 = IO-Link, Push/pull  
 CH2 = PNP only output or input

## Output Rating

100 mA maximum load each output (derate 1 mA per °C above 30° C)  
 100 mA max total load current for sensor  
**OFF-state leakage current:** < 5 µA PNP at 30 V dc (N.A. push/pull);  
**ON-state saturation voltage:** < 2 V

## Required Overcurrent Protection



**WARNING:** Electrical connections must be made by qualified personnel in accordance with local and national electrical codes and regulations.

Overcurrent protection is required to be provided by end product application per the supplied table.  
 Overcurrent protection may be provided with external fusing or via Current Limiting, Class 2 Power Supply.  
 Supply wiring leads < 24 AWG shall not be spliced.  
 For additional product support, go to [www.bannerengineering.com](http://www.bannerengineering.com).

Supply Wiring (AWG)	Required Overcurrent Protection (Amps)
20	5.0
22	3.0
24	2.0
26	1.0
28	0.8
30	0.5

## IO-Link Interface

**Supports smart sensor profile:** Yes  
**Baud rate:** 38400 bps  
**Process data widths:** 16 bits  
**IODD files:** Provides all programming options of the display, plus additional functionality

## Output Protection

Protected against output short-circuit, continuous overload, transient overvoltages, and false pulse on power-up

## Construction

Black ABS/polycarbonate alloy (UL94 V-0 rated) housing, clear polycarbonate cover

## Connections

PVC jacketed 2 m (6.5 ft) 4-wire integral cable; or integral 4-pin M8/Pico-style quick disconnect; or 150 mm (6 inch) cable with a 4-pin M12/Euro-style quick disconnect; or 150 mm (6 inch) cable with a 4-pin M8/Pico-style quick disconnect

## Adjustments

- 3-way RUN/PRG/ADJ Mode Switch
- 2-way CH1/CH2 Switch
- 3-way +/-SET/- Rocker Button
  - Expert-style teaching (Two-Point and Dynamic TEACH, Light/Dark/Window/Calibration SET)
  - Manually adjust sensitivity (from "+" and "-" rocker button only)
  - Response Speed, TEACH Selection, Offset Percent, Auto Thresholds, Delays/Timers, Display Readout, Gain Selection, Factory Defaults (from top panel or remote input)
  - Top panel interface lockout (from remote input only)

## Indicators

**Red 4-digit Display:** Signal Level  
**Green 4-digit Display:** Threshold  
 (In Program Mode, Red and Green displays are used for programming menus)  
**Amber LED:** Output conducting

## Environmental Rating

IEC IP50, NEMA 1

## Operating Conditions

**Temperature:** -10 °C to +55 °C (+14 °F to +131 °F)  
**Storage Temperature:** -20 °C to +85 °C (-4 °F to +185 °F)  
**Humidity:** 90% at +60 °C maximum relative humidity (non-condensing)

## Certifications



## Response Speed

Description	Response Speed	Repetition Period	Repeatability	Cross-Talk Avoidance	Energy Efficient Light Resistance	Maximum Range, Red <sup>3</sup>	Maximum Range, IR850 <sup>4</sup>
Fast	50 us	12 us	12 us	No	No	500	750
Standard	250 us	50 us	50 us	Yes	No	725	1300
Medium Range	500 us	80 us	80 us	Yes	No	900	1600
Long Range	1000 us	165 us	165 us	Yes	No	1100	2100
Long Range (with Immunity)	2000 us	165 us	165 us	Yes	Yes	1100	2100

<sup>3</sup> Excess Gain = 1 at High Sensitivity setting; opposed mode sensing using PIT46U plastic fiber  
<sup>4</sup> Excess Gain = 1 at High Sensitivity setting; opposed mode sensing using IT.83.3ST5M6 glass fiber

## Banner Engineering Corp. Limited Warranty

---

Banner Engineering Corp. warrants its products to be free from defects in material and workmanship for one year following the date of shipment. Banner Engineering Corp. will repair or replace, free of charge, any product of its manufacture which, at the time it is returned to the factory, is found to have been defective during the warranty period. This warranty does not cover damage or liability for misuse, abuse, or the improper application or installation of the Banner product.

**THIS LIMITED WARRANTY IS EXCLUSIVE AND IN LIEU OF ALL OTHER WARRANTIES WHETHER EXPRESS OR IMPLIED (INCLUDING, WITHOUT LIMITATION, ANY WARRANTY OF MERCHANTABILITY OR FITNESS FOR A PARTICULAR PURPOSE), AND WHETHER ARISING UNDER COURSE OF PERFORMANCE, COURSE OF DEALING OR TRADE USAGE.**

This Warranty is exclusive and limited to repair or, at the discretion of Banner Engineering Corp., replacement. **IN NO EVENT SHALL BANNER ENGINEERING CORP. BE LIABLE TO BUYER OR ANY OTHER PERSON OR ENTITY FOR ANY EXTRA COSTS, EXPENSES, LOSSES, LOSS OF PROFITS, OR ANY INCIDENTAL, CONSEQUENTIAL OR SPECIAL DAMAGES RESULTING FROM ANY PRODUCT DEFECT OR FROM THE USE OR INABILITY TO USE THE PRODUCT, WHETHER ARISING IN CONTRACT OR WARRANTY, STATUTE, TORT, STRICT LIABILITY, NEGLIGENCE, OR OTHERWISE.**

Banner Engineering Corp. reserves the right to change, modify or improve the design of the product without assuming any obligations or liabilities relating to any product previously manufactured by Banner Engineering Corp. Any misuse, abuse, or improper application or installation of this product or use of the product for personal protection applications when the product is identified as not intended for such purposes will void the product warranty. Any modifications to this product without prior express approval by Banner Engineering Corp will void the product warranties. All specifications published in this document are subject to change; Banner reserves the right to modify product specifications or update documentation at any time. Specifications and product information in English supersede that which is provided in any other language. For the most recent version of any documentation, refer to: [www.bannerengineering.com](http://www.bannerengineering.com).

For patent information, see [www.bannerengineering.com/patents](http://www.bannerengineering.com/patents).